



Seals

DATE:

MASTER PLAN / PRELIMINARY PLAT
SUNBRIDGE NEIGHBORHOOD 7

CITY OF ORLANDO, FLORIDA

DOCUMENT CHANGES			
Description	Date		
REVISED PER INTERNAL REVIEW	7/17/25		
Issue Description			
Issue Date	5/14/25		
Project No	25506		
Drawn/Designed	CWG / WCW	Checked By	JTT
Drawing Title			

STORMWATER MASTER PLAN

Sheet Number

5 OF 5

1. THE LANDS SHOWN HEREON WITHIN PARCEL N-7 WILL BE PART OF A PUBLIC SUBDIVISION.
2. ALL DRAINAGE INFORMATION IS CONCEPTUAL AND IS SUBJECT TO CHANGE BASED ON FINAL ENGINEERING DESIGN, FINAL PLAT, AGENCY REVIEW AND APPROVAL.
3. THE PROPERTY PHASING DEPICTED HEREON MAY BE DEVELOPED IN ANY ORDER, PROVIDED THAT EACH PHASE OR SUB-PHASE FUNCTIONS IN A STAND-ALONE CONDITION.
4. ELEVATIONS SHOWN HEREON ARE RELATIVE TO NAVD88 VERTICAL DATUM AS MEASURED FROM BENCHMARKS PROVIDED BY NGS (NATIONAL GEODETIC SURVEY). SEE SURVEY OF SUBJECT PROPERTY FOR REFERENCE BENCHMARKS.

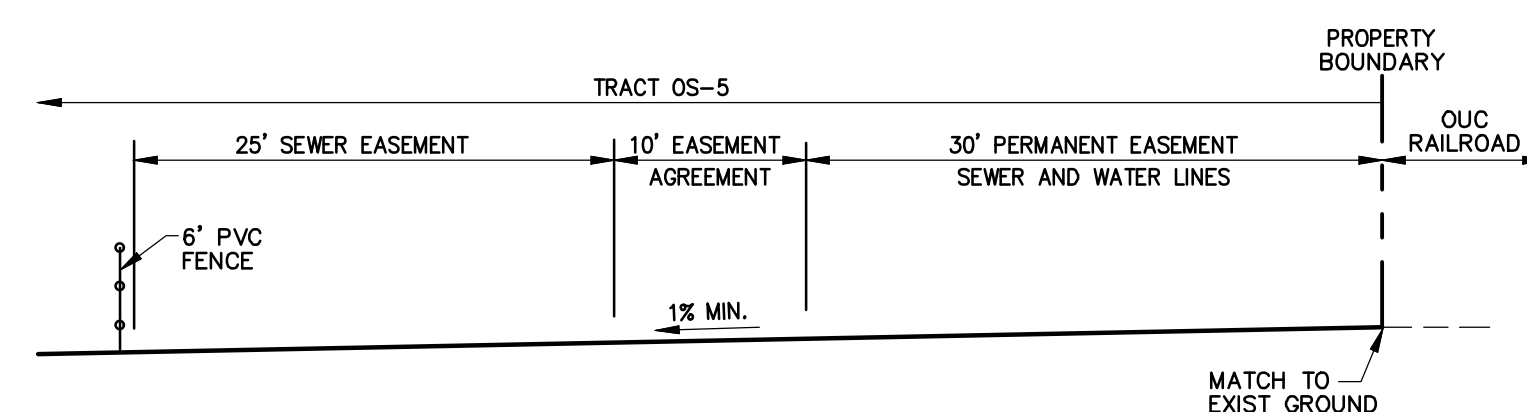
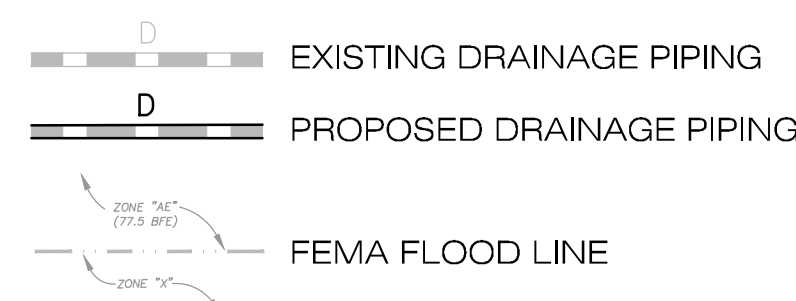

SECTION A-A

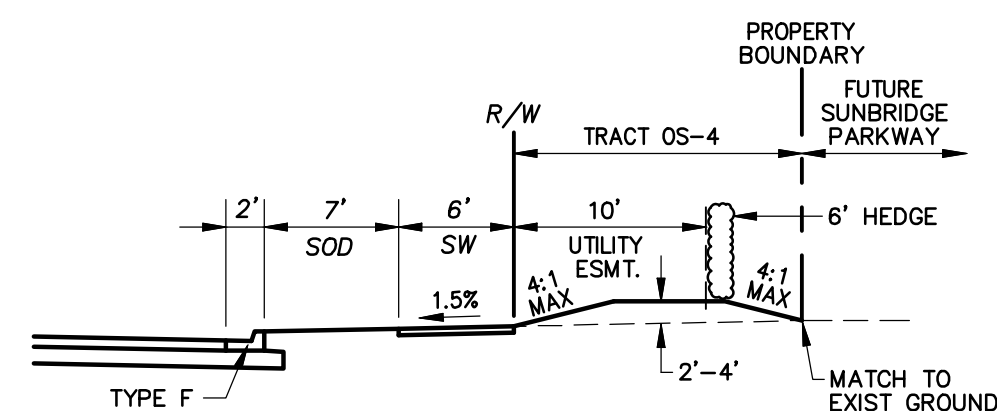

SECTION B-B

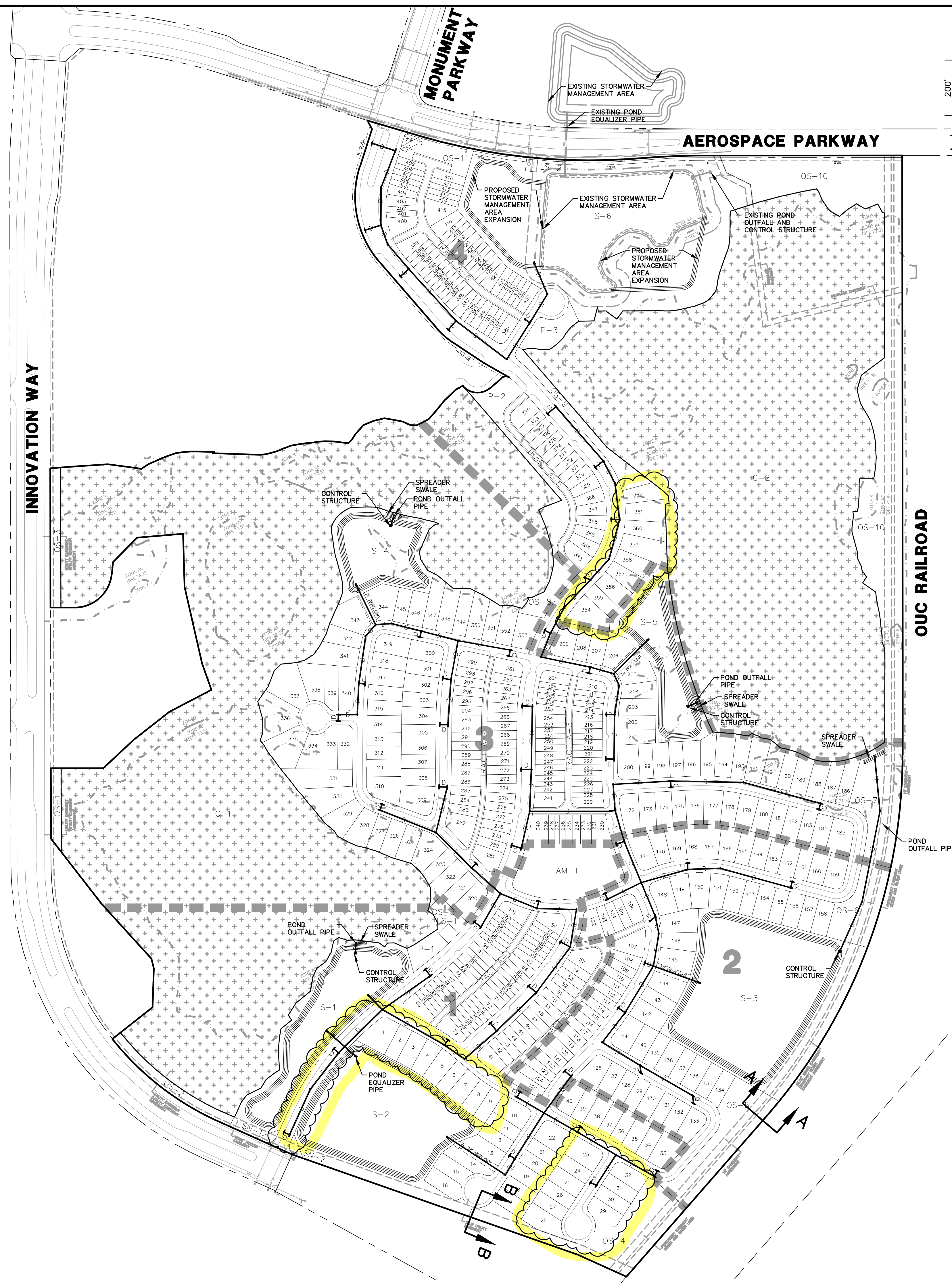

DONALD W. MCINTOSH ASSOCIATES, INC. RESERVES THE EXCLUSIVE COPYRIGHT AND PROPERTY RIGHTS TO THIS DRAWING WHICH MAY NOT BE REPRODUCED, CHANGED, OR COPIED IN ANY FORM OR MANNER, NOR CAN IT BE ASSIGNED TO ANY PARTY WITHOUT DONALD W. MCINTOSH ASSOCIATES, INC.'S WRITTEN CONSENT.

File: 2025\25506_PSD\Fig-25506-N7-PNCG.dwg
Toll Free: 800-955-5506