

NOTES

1. THE LANDS SHOWN HEREON WITHIN NEIGHBORHOOD 7 WILL BE PART OF A PUBLIC SUBDIVISION.
2. ALL UTILITY INFORMATION IS CONCEPTUAL AND IS SUBJECT TO CHANGE BASED ON FINAL ENGINEERING DESIGN, FINAL PLATTING, AGENCY REVIEW AND APPROVAL.
3. FIRE HYDRANTS ARE TO BE SPACED NO FURTHER THAN 1000 FEET APART. AT LEAST ONE FIRE HYDRANT TO BE WITHIN 500' OF EACH STRUCTURE. DEPENDING ON THE FIRE FLOW DEMAND FOR EACH STRUCTURE, ONE OR MORE FIRE HYDRANTS WILL BE REQUIRED TO BE WITHIN THIS 500' RANGE. ONE FIRE HYDRANT SHALL BE LOCATED AT SUBDIVISION ENTRANCES.
4. THE SIZES OF UTILITY LINES SHOWN HEREON WILL BE DETERMINED WITH FINAL ENGINEERING.
5. THE PROPERTY PHASING DEPICTED HEREON MAY BE DEVELOPED IN ANY ORDER, PROVIDED THAT EACH PHASE OR SUB-PHASE FUNCTIONS IN A STAND-ALONE CONDITION.
6. TRACT OS-13 SHALL HAVE AN UTILITY EASEMENT DEDICATED TO ORANGE COUNTY UTILITIES.

LEGEND

— W —	PROPOSED POTABLE WATER MAIN
— R —	PROPOSED RECLAIMED WATER MAIN
⊗ S ⊗	PROPOSED SANITARY SEWER GRAVITY MAIN
— FM —	PROPOSED FORCE MAIN
— 8W —	EXISTING POTABLE WATER MAIN
— 6R —	EXISTING RECLAIMED WATER MAIN
⊗ 8FM ⊗	EXISTING SANITARY SEWER GRAVITY MAIN
— 8FM —	EXISTING FORCE MAIN

INNOVATION WAY

MONUMENT PARKWAY

AEROSPACE PARKWAY

OCU RAILROAD

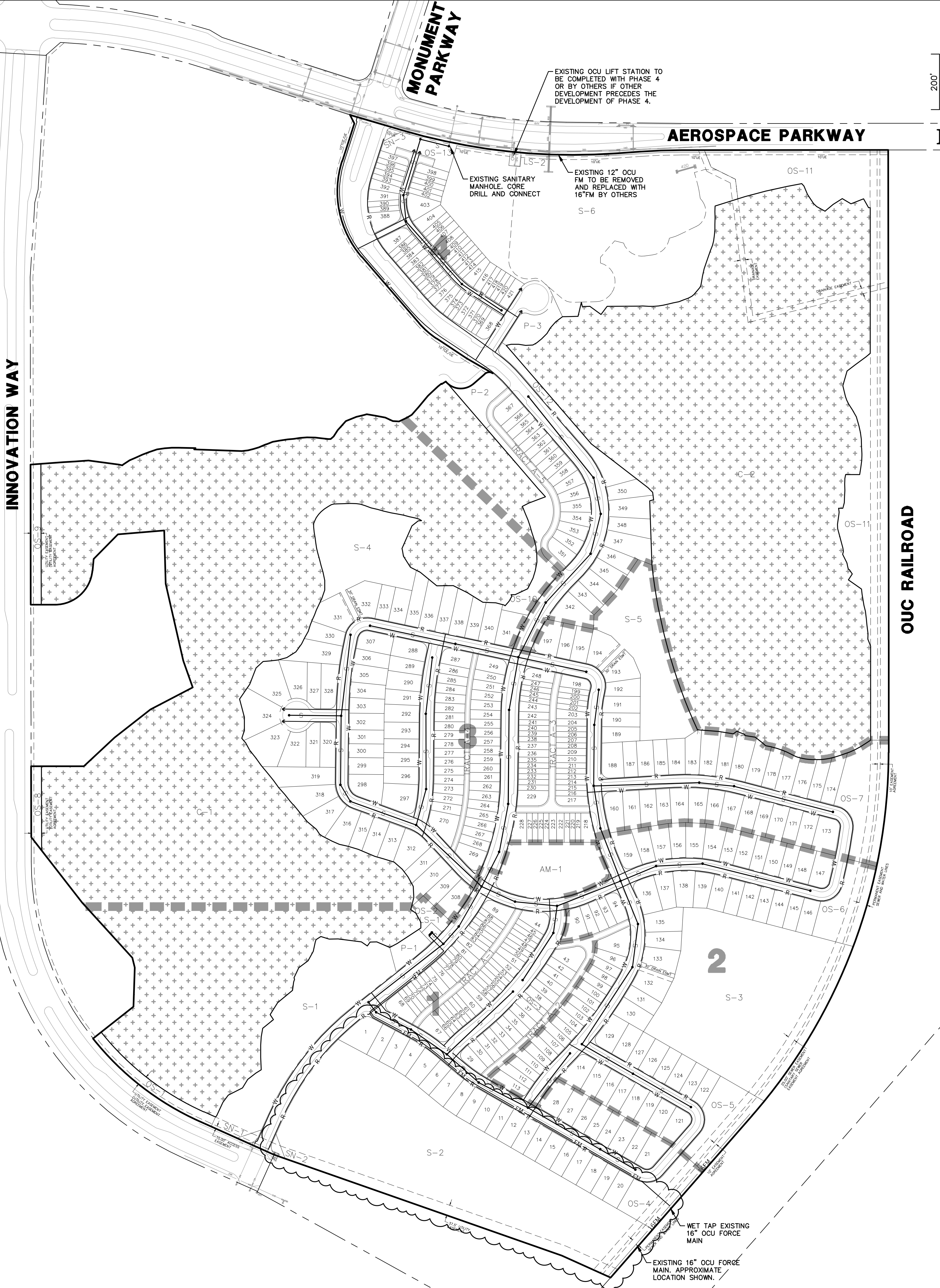
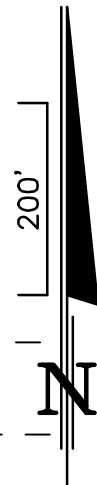

MASTER PLAN / PRELIMINARY PLAT SUNBRIDGE NEIGHBORHOOD 7

CITY OF ORLANDO, FLORIDA

DOCUMENT CHANGES

Description	Date
REVISED PER INTERNAL REVIEW	7/17/25
REVISED PER APPLICANT REQUEST	9/12/25

Issue Description	
Issue Date	5/14/25
Project No	25506
Drawn/Designed	CWG / WCW
Checked By	JTT
Drawing Title	

WATER, SEWER & RECLAIMED MASTER PLAN

Sheet Number	4
	4 OF 7