

CANOPY TREE PLANTING DETAIL
NOT TO SCALE

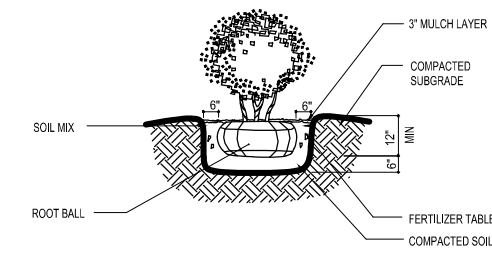

SHRUB PLANTING DETAIL
NOT TO SCALE

TREE SCHEDULE

SYMBOL USED ON PLAN		PLANT NAME		NATIVE SPECIES		CALIPER		HEIGHT		QUANTITY	COMMENTS
Symbol	New	Scientific	Common	Yes	No	Installed	Mature	Type			
AR	*	Acer Rubrum	Red maple	*		4"	15'-0"	50'-0"	C	10	
QV	*	Quercus Virginiana	Live Oak	*		4"	15'-0"	60'-0"	C	3	
U	*	Lagerstroemia Indica	Crape Myrtle	*		2"	12'-0"	25'-0"	U	14	
CC	*	Cercis Canadensis	Eastern Redbud	*		2"	12'-0"	20'-0"	U	4	
LU	*	Ligustrum Japonicum	Waxleaf Privet	*		2"	12'-0"	20'-0"	U	8	
TOTAL										39	

C = Canopy Trees U = Understory Trees
Contact the Bureau of Parks (407) 246-2283 for a tree removal permit before removing any 4" caliper or larger trees.

VINE, SHRUB AND GROUND COVER SCHEDULE

SYMBOL USED ON PLAN		PLANT NAME		NATIVE SPECIES		HEIGHT		QUANTITY	COMMENTS	
Symbol	New	Scientific	Common	Yes	No	Installed	Mature			
TJ	*	Trachelospermum Jasminoids	Confederate Jasmin	*		2'-6"	10'-0"	2	Vines to be planted in front of ecoMESH	
TJ		Trachelospermum Jasminoids	Confederate Jasmin	*		2'-6"	10'-0"	70	Vines to be planted in front of ecoMESH	
VO		Viburnum Obovatum	Mrs. Schillers Dwarf	*		1'-6"	3'-0"	103	Shrub, plant at 36" O.C.	
SE		Sabal Minor	Dwarf Palmetto	*		1'-6"	3'-0"	25	Shrub, plant at 42"-48" O.C.	
CI		Chrysobalanus Icaco	Horizontal Cocoplum	*		1'-6"	3'-0"	31	Shrub, plant at 42"-48" O.C.	
ZF	*	Zamia Floridana	Coontie	*		1'-6"	3'-0"	46	Ground Cover, plant at 42" O.C.	
ZF		Zamia Floridana	Coontie	*		1'-6"	3'-0"	83	Ground Cover, plant at 42" O.C.	
CA	*	Crinum americanum	Swamp Lily	*		1'-6"	3'-0"	69	Ground Cover, plant at 42" O.C.	
RA	*	Rhododendron austrinum	Florida Flame Azalea	*		1'-6"	6'-0"	39	Shrub, plant at 36" O.C.	
CF	*	Canna flaccida	Wild Cannas	*		6'-9"	4'-0"	12	Ground Cover, plant at 18"-32" O.C.	
LD	*	Lantana Depressa	Yellow Pineland Lantana	*		6'-9"	1'-0"	149	Ground Cover, plant at 18"-32" O.C.	
TOTAL									638	

NOTE: VINES ARE NOT PART OF SHRUB TOTAL COUNT.
EXISTING LANDSCAPE MUST BE INSPECTED FOR DAMAGED TREES AND SHRUBS MUST BE REPLACED

MU-1	Sq. Ft.	Acres
Gross Area	91,101.06	2.09
R.O.W Dedication	-	0.00
Net Area	91,101.06	2.09

MU-1 - Landscape Data	Allwd./Reqd.	Provided
Shade Coverage Requirements		
Minimum Shade Coverage - 60.241		
Tree Requirement: 15 points per acre		
1.65 acres x 15 =	24.75 points	
Small Trees = 24.75 x 20% =	4.95 points	
Medium Trees = 24.75 x 10% =	2.47 points	
Large Trees = 24.75 x 10% =	2.47 points	
Large tree substitution		
2.47 points / 2 =	1.235 points	
Total Medium Tree Points	3.70 points	

Parking Lot Landscaping		
Landscape Adjacent to Street - 60.252		
Canopy Tree Requirement: 3 points per 100 lf		
514 lf frontage / 100 =	5.14	
5.14 x 3 =	15.42 points	16 points
Landscape Adjacent to Contiguous Properties - 60.253		
Canopy Tree Requirement: 2 points per 100 lf		
555 lf interior lots / 100 =	5.55	
5.55 x 2 =	11.1 points	12 points
Landscape in Interior Areas - 60.254		
28,059.15 x 2.5% =	701.47 sf	2,437 sf
701.47 sf / 100 =	7.01 points	8 points
Total Canopy Tree Points		36 Points

Trees Provided		
Canopy: 36/3 (med. installed native) =	12	13
Understory: (small installed native) =	N/A	26

GENERAL PLANTING NOTES:

- IRRIGATION IS REQUIRED, SEE SHEET L-3 FOR MORE INFO. PROVIDE AUTOMATIC RAIN SENSOR. NO INDIVIDUAL PUMP SHALL EXCEED 25 HORSEPOWER (SEE IRRIGATION PLAN)
- ALL PLANT MATERIAL MUST BE FLORIDA NO. 1 OR BETTER BY GRADES & STANDARDS FOR NURSERY PLANTS. PART 1, 1975 AND PART II, STATE OF FLORIDA D & A.
- GRASS SOD SHALL BE CLEAN AND REASONABLY FREE OF WEED AND NOXIOUS PESTS OR DISEASES. BY THE SQUARE FOOT, SOD MUST BE 90% SPECIES (ST. AUGUSTINE)
- ALL AREAS NOT DEDICATED TO BUILDINGS, DRIVEWAYS, WALKWAYS OR LANDSCAPING SHALL BE SODDED.
- PLANTING SOIL SHALL BE CLEAR AND REASONABLY FREE OF CONSTRUCTION DEBRIS, WEEDS AND ROCKS. THE PLANTING SOIL FOR ALL PLANTING AREAS SHALL BE COMPOSED OF A MINIMUM OF 30% MUCK OR HORTICULTURALLY ACCEPTABLE ORGANIC MATERIAL. THE MINIMUM PLANTING SOIL DEPTH SHALL BE 2" FOR SODDED GRASS AREAS & 4" FOR PLANTING BEDS. ALL TREES, SHRUBS AND GROUND COVER AREAS MUST USE PLANTING SOIL IN INSTALLATION.
- MULCH: A MINIMUM OF 3" OF SETTLED, CLEAN, NONCYPRESS, GRADE B SHREDDED MULCH SHALL BE USED (ARSENIC FREE) & SHALL NOT TOUCH BASE OF TREE). MULCHED AREAS AROUND TREES AND PALMS SHALL BE A MINIMUM OF 2' AROUND THE BASE OF THE TREE.
- ALL TREES, SHRUBS AND PALMS SHALL BE PLANTED WITH A MINIMUM OF 6" OF PLANTING SOIL AROUND THE UPPER 1/3 OF THE ROOT BALL. THE BOTTOM 2/3 SHALL BE BACK FILLED WITH SOIL FROM THE PLANT HOLE AND BE ROCK FREE.
- ALL TREES AND PLANTS SHALL BE PROPERLY GUYED AND STAKED AT THE TIME OF PLANTING TO ENSURE ESTABLISHMENT AND ERECT GROWTH. TREES AND PALMS SHALL BE RE-STAKED IN THE EVENT OF A BLOW-OVER OR OTHER FAILURE OF STAKING OR GUYING. NAIL STAKING OR OTHER METHODS WHICH CAUSE COSMETIC OR BIOLOGICAL DAMAGE TO THE TREE ARE PROHIBITED.

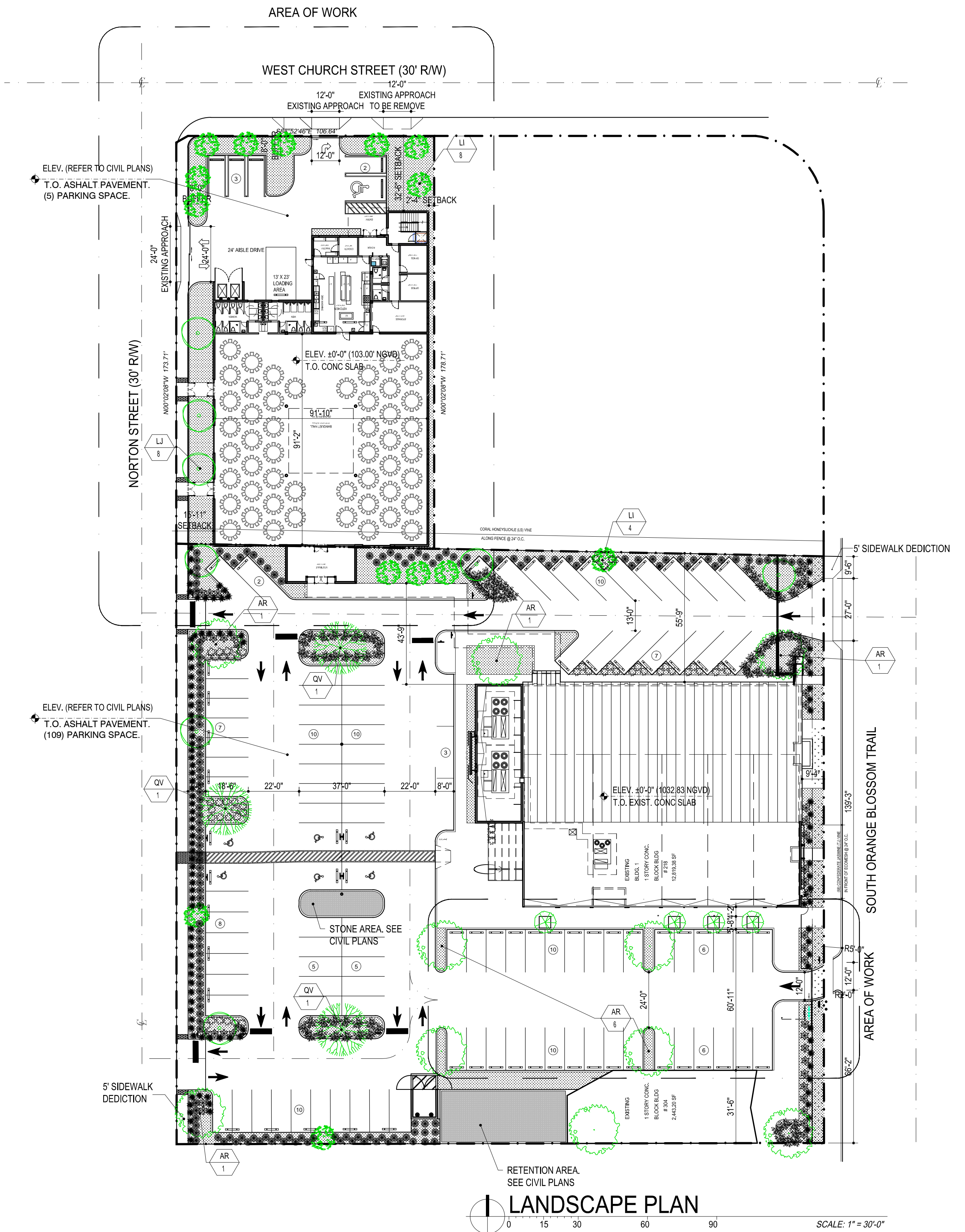

09/25/2023
HUMBERTO RAMOS AR 001783

FELLOWSHIP HALL
FOR
First Haitian Free Church of Nazarene by Faith
AT
1314 WEST CHURCH STREET
ORLANDO, FLORIDA 32805

LANDSCAPE PLAN

REVISIONS:

COMM. NO. 19-124

DATE: November 15, 2019

DRAWN BY:

CHECKED BY: